

DETER. DETECT. DELAY. DENY.

Transcend Security's solar-powered **s360 Standard Mobile Surveillance Unit** is a low-cost alternative to physical security guards and a more secure option than periodic security vehicle patrols.



KEY FEATURES

Each unit is equipped with the base features described below.

- A 360°, Multisensor camera with four (4) 5MP image sensors and 2.5x optical zoom.
- Intrusion detection with two (2)-way, one (1)-click horn speaker.
- Extendable 25-foot mast with 360° viewing potential.
- A built-in, 1440 total wattage four (4)-panel solar array.
- Two (2) 40K lumen "Set-and-Forget" LED lights.
- Controls for built-in battery monitor, light switch controls, and solar array adjuster.
- Rapid deployment with 4G connectivity, eliminating the need for Wi-Fi connection.
- Optional Starlink Internet available.

Still not convinced?
Ask about our 7-day trial.

SENTRY MODE ACTIVATED.

Transcend Security's outdoor **Sentry Mobile Surveillance Unit** is a stand-alone mobile security solution for a wide range of sites. Needing just an unobstructed southern sun exposure and a flat surface for deployment, this unit comes with a retractable pole for optimal viewing range.



KEY FEATURES

Each unit is equipped with the base features described below.

- Intrusion detection with two (2)-way, one (1)-click horn speaker.
- High-efficiency solar panel with up to 100 watts of power.
- Dual LED light panes with dusk to dawn operation.
- Operational storage with built-in battery monitor and LiFePO4 battery for 24/7 operation.
- A 360°, Multisensor camera with four (4) 5MP image sensors and 2.5x optical zoom..
- Wireless router and Air Card.
- Rapid deployment with 4G connectivity, eliminating the need for Wi-Fi connection.
- Two (2) alternating LED strobe panels for deterrence.

TRANSCEND ANYWHERE, TRANSCEND EVERYWHERE.

Transcend Security's ConneX installation makes it quick and easy to **deploy your choice of camera**. All that's needed is a plug and an outlet and we can monitor anywhere.

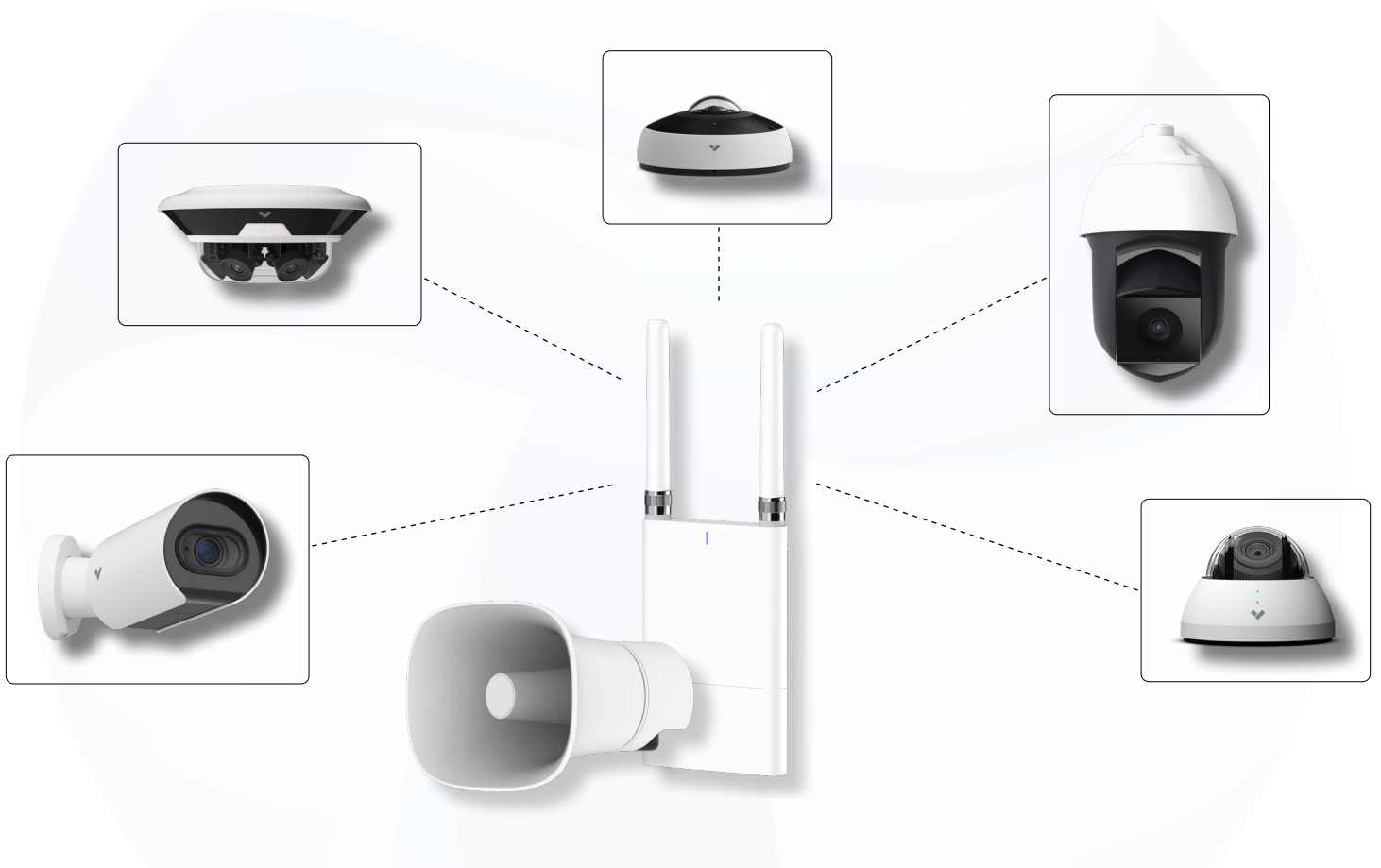

ANALYTICS & KEY FEATURES

Each system is customizable with the cameras described below.

The ConneX includes a two-way Horn Speaker and a wireless Cellular Gateway.

All that's left to do is pick your camera. Choose from five (5) cloud-managed cameras (as pictured from left to right):

1. **Bullet** with LPR capabilities,
2. **Multisensor** with 4 camera heads and 2.5x zoom,
3. **Fisheye** with 360° Panoramic,
4. **PTZ** with 360° pan and 270° tilt equipped with Sentry Mode, or
5. **Dome** with 130m of IR range.

Camera Analytics. Each camera is equipped with advanced analytics like People and Vehicle Search and Filters, People and Vehicle of Interest Notifications, and Motion Notifications.

VERKADA COMMAND

Connect all of your Verkada devices in a single, cloud-based platform. With point-and click simplicity, it's everything you need to protect at scale.



Investigate with Ease

Search for people and vehicles across an entire camera fleet using your own words to conduct the investigations with AI-powered query search.



Quick Threat Detection

Aggregate data across devices within a single platform. View activity across all sites to easily detect threats and expedite response times.



Scale with Simplicity

Add devices in minutes, while leveraging roles and permissions to manage users at scale.



Notifications

Enable proactive monitoring with alerts for events like motion, tampering, and People and License Plates of Interest.



Motion Search

Instantly replay videos and view detected person trajectories for fast, efficient searching.



Live viewing

Customize Grids with up to 12 live camera feeds and enable auto-rotation through personalized Grid views on timed cycles.

MONITORING & ALARM VALIDATION

Our TSOC Analysts live monitor cameras and respond to all alarms and notification triggers **Monday-Friday from 6:00 PM to 6:00 AM** and for **24 hours on weekends**.

Incident-based monitoring— After-hours monitoring of incident-based alerts.

After-Hours Virtual Tours— Scheduled virtual property tours and activity reports.

Passive Capture— General camera recording and capture from cameras.

Defined Incident— Specific event and People, Vehicle, or Motion of Interest monitoring.

Alarm Validation Scoring Standard

The Alarm Validation Scoring Standard **ensures incidents are responded to appropriately and quickly** by emergency services or law enforcement.

Incidents are coded by threat level—unknown intent threat, active (legitimate) threat, imminent (life-threatening). Threat level is then communicated to emergency response or law enforcement to ensure the correct response to the situation.

 THREAT ALERT

 ANALYST ACTION

 DISPATCH ALERTING

 INCIDENT RECAP

Interested?

Reach out to us via email.

www.transcendsecurity.com

sales@transcendsecurity.com